

FEATURES

- Full Range of Feature and Performance Options
- Standard Single and Full Board Heights, Custom Sizes Available Upon Request
- Foam Gasket
- Overlay or Silkscreen
- Custom Overlays Available
- Overlay Gallery to Ensure Crisp Aesthetics
- Filler Panels also Available
- Snag-Resistant Gasket Curb also Enhances EMI Integrity
- Tampered Lead-In on Side Flanges to Guarantee Smooth Insertion
- 1.0mm Thick Face for Robust Connector Cutouts
- Assembled and Ready to Attach to Your Module PCB



XTech — The Front Panel Source

Standard AMC Front Panels are Now Supported by the XTech XPRESS Program!

XPRESS FROM START TO FINISH

Drawings Online for Easy Access / Modification

Online Quote Request

Engineering Documentation and Approvals - XPRESS Style

Production - 15 Days on New Orders; 10 Days on Reorders

AMC Front Panels are Assembled and Ready to Go!

Contact our Sales Department by Phone at 1-888-444-1644 or by Email at xpresssales@xtech-outside.com For More Information



AdvancedMC™

Aluminum and Stainless Steel
Front Panel Assemblies

Specifications

	Aluminum	Stainless Steel
Finish	Trivalent Chromate	Clear Passivation
Dual Light Pipe	Polycarbonate	Polycarbonate
PCB Screws	Stainless Steel with Locking Patch	Stainless Steel with Locking Patch
Hot Swap Latch Handle	Zinc-Alloy and Stainless Steel with Powder Coated Handle	Zinc-Alloy and Stainless Steel with Powder Coated Handle
Gasket	Fabric over Foam	Fabric over Foam
Custom Overlay	0.25mm Velvet Matte Polycarbonate	0.25mm Velvet Matte Polycarbonate

Standard AMC Configurations - Let us customize these to meet your requirements:

Overlays
Silkscreening
Connector Cutouts
Custom Cable Management



AMC Single Compact Configurations



AMC Single Mid-Size Configurations



AMC Single Full-Size Configurations

Special Order Kits



AMC Double Compact Configurations



AMC Double Mid-Size Configurations



AMC Double Full-Size Configurations

Customizable Solution with
Integral Cable Management

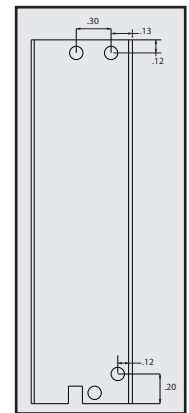
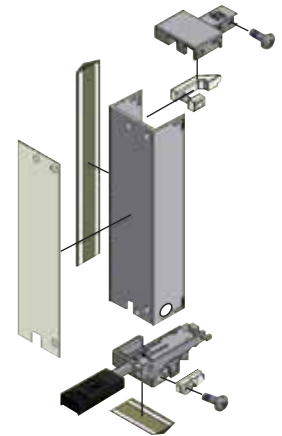

Locations of LED holes on standard AMC panels



sales@xtech-outside.com
358 North Street, Randolph, MA 02368
www.XTech-Outside.com
US Sales: 1-888-444-1644
China Sales: 86-592-5765365