

## FEATURES

- Full Range of Feature and Performance Options
- Standard Single and Full Board Heights, Custom Sizes Available Upon Request
- Foam Gasket
- Overlay or Silkscreen
- Custom Overlays Available
- Overlay Gallery to Ensure Crisp Aesthetics
- Filler Panels also Available
- Snag-Resistant Gasket Curb also Enhances EMI Integrity
- Tapered Lead-In on Side Flanges to Guarantee Smooth Insertion
- 1.0mm Thick Face for Robust Connector Cutouts
- Assembled and Ready to Attach to Your Module PCB



## XTech — The Front Panel Source

Standard AMC Front Panels are Now Supported by the XTech XPRESS Program!

### XPRESS FROM START TO FINISH

Drawings Online for Easy Access / Modification

Online Quote Request

Engineering Documentation and Approvals - XPRESS Style

Production - 15 Days on New Orders; 10 Days on Reorders

AMC Front Panels are Assembled and Ready to Go!

Online Design Assistance - download our overlay templates as part of the STP files on-line!

Contact our Sales Department by Phone at 1-888-444-1644 or by Email at [xpresssales@xtech-outside.com](mailto:xpresssales@xtech-outside.com) For More Information



# AdvancedMC™

Aluminum and Stainless Steel  
Front Panel Assemblies

Customizable Solution with  
Integral Cable Management



## SPECIFICATIONS

	Aluminum	Stainless Steel
Finish	Trivalent Chromate	Clear Passivation
Dual Light Pipe	Polycarbonate	Polycarbonate
PCB Screws	Stainless Steel with Locking Patch	Stainless Steel with Locking Patch
Hot Swap Latch Handle	Zinc-Alloy and Stainless Steel with Powder Coated Handle	Zinc-Alloy and Stainless Steel with Powder Coated Handle
Gasket	Fabric over Foam	Fabric over Foam
Custom Overlay	0.25mm Velvet Matte Polycarbonate	0.25mm Velvet Matte Polycarbonate
RoHS	Compliant	Compliant
PICMG	AMC.0 Rel 2.0	AMC.0 Rel 2.0



Standard AMC Configurations - Let us customize these to meet your requirements:

- Overlays
- Silkscreening
- Connector Cutouts
- Custom Cable Management

Kit Includes:

- Front Panel
- Latch and Handle Assembly
- EMI Gasket Set
- Lightpipe Bracket Assembly
- Hot Swap Lightpipe
- PCB Attachment Screws (2)
- Assembly Guide



AMC Single Compact Configuration



AMC Single Mid-Size Configuration



AMC Single Full-Size Configuration

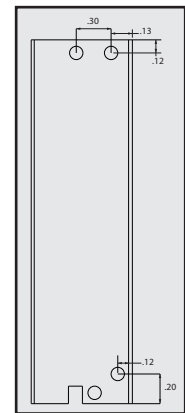
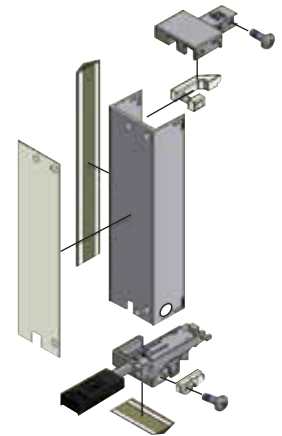

Locations of LED holes on standard AMC panels

Special Order



AMC Double Mid-Size Configuration



AMC Double Full-Size Configuration



AMC Double Compact Configuration



Height	Width	Material	P/N
Single	Compact	AL	127268
Single	Mid-Size	AL	127272
Single	Full-Size	AL	127270
Double	Compact	AL	127262
Double	Mid-Size	AL	127266
Double	Full-Size	AL	127264
Single	Compact	ST	127269
Single	Mid-Size	ST	127273
Single	Full-Size	ST	127271
Double	Compact	ST	127263
Double	Mid-Size	ST	127267
Double	Full-Size	ST	127265
AL = Aluminum			
ST = Stainless Steel			



sales@xtech-outside.com  
358 North Street, Randolph, MA 02368  
www.XTech-Outside.com  
US Sales: 1-888-444-1644  
China Sales: 86-592-5765365